

HB-12

ANTI-VIBRATION

Adjustable Hydraulic Dampers

20N - 180N, 10 - 80mm Stroke

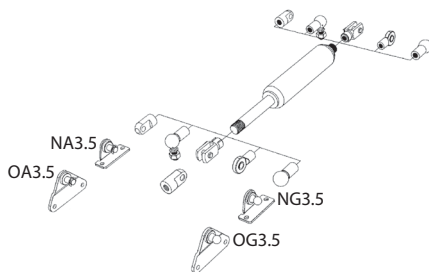

Optional Mounting Brackets

For Fixed Eyes: NA3.5 (180N) - £7.98 OA3.5 (180N) - £9.25

For Ball Sockets: NG3.5 (180N) - £P.O.A OG3.5 (180N) - £P.O.A

See Technical for dimensions of mounting brackets.

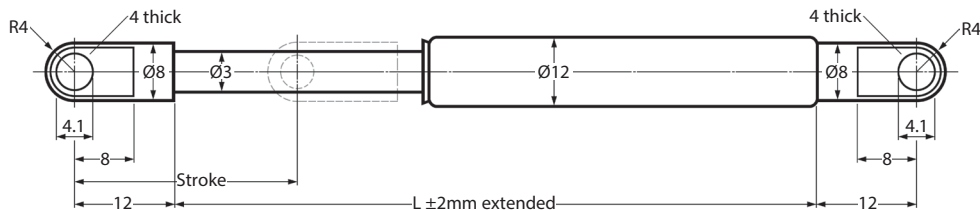

Optional End Fittings

Swivel Eye (370N)	£P.O.A	Angle Ball Joint (370N)	£P.O.A	Plain Stud Threads	£P.O.A	See Technical for dimensions of optional end fittings.
Clevis Fork (370N)	£P.O.A	Ball Socket (370N)	£P.O.A	Rod shrouds	£P.O.A	

Discounts: 10+ -5%	25+ -10%	50+ -15%	100+ -20%
--------------------	----------	----------	-----------

Part Number	Stroke Extension	L	Max. Compression Force N	Mass Kg	Price Each 1 - 9
HB-12-10-AA-P	10	55	180	-	£108.16
HB-12-20-AA-P	20	75	180	-	£108.16
HB-12-30-AA-P	30	95	180	-	£109.98
HB-12-40-AA-P	40	115	180	-	£109.98
HB-12-50-AA-P	50	135	180	-	£115.89
HB-12-60-AA-P	60	155	180	-	£115.89
HB-12-70-AA-P	70	175	180	-	£119.59
HB-12-80-AA-P	80	195	150	-	£119.59

Material

Body: Black powder coated Steel.**Piston Rod:** 303 Stainless Steel.**End Fittings:** Zinc plated Steel.**Operating Temperature Range:** -20°C to +80°C.**Operating Fluid:** Hydraulic oil.**Free Travel:** Approx. 21 % of stroke.

Positive mechanical stops 1 to 1.5mm before end of each stroke direction.

Options

P = Damping in both stroke directions (Standard)**M** = Damping on out stroke only (Available on Request)**N** = Damping on in stroke only (Available on Request)

These models provide damping effects either in one direction with free return, or both directions.

Alternative end fittings available, P.O.A.

‘Eye’ type end fitting supplied as standard, please refer to Technical for options.

End fittings are glued on as standard. If you require the end fittings to be separate, please add **-SEP** to the end of the part number.Eg: **HB-12-20-AA-P-SEP**

Features

- Constant speed rates
- Bi-directional damping with precise control of speed in both directions of travel
- Easy mounting
- Individual filling by valve technology
- Calculation program for individual design
- Maintenance-free, self-contained, closed system unit.
- Long service life
- High quality
- As a safety device they prevent sudden movement.

Other Info.

Adjustment of the damping rate is handled, in the opposite way to the dampers HB-15 to HB-70, via the cylinder stud thread. The damping force can be precisely regulated by using a screwdriver. Adjusted at the end of stroke.

Mounting in any position, end fittings must be positively secured to prevent unscrewing. When used as a compensating feature on an application they smoothly dampen swinging loads.

When used with a “drive actuator” these always ensure a uniform traverse speed.



+44 (0)1246 455500



+44 (0)1246 455522

ondrives<https://amironic.co.uk/>

sales@ondrives.com



www.ondrives.com

ANTI-VIBRATION

Adjustable Hydraulic Dampers

20N - 800N, 25 - 150mm Stroke

HB-15

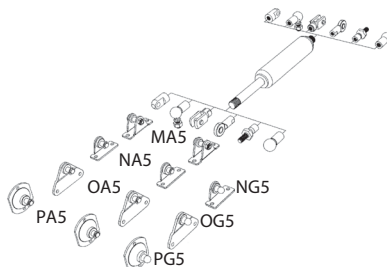

Optional Mounting Brackets

For Fixed & Swivel Eyes: MAS (500N) - £P.O.A NA5 (400N) - £9.56 OA5 (180N) - £8.24 PA5 (500N) - £P.O.A

For Ball Sockets: NG5 (400N) - £P.O.A OG5 (180N) - £P.O.A PG5 (500N) - £P.O.A

See Technical for dimensions of mounting brackets.

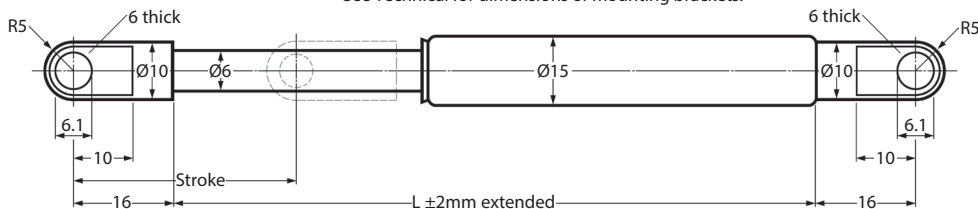

Optional End Fittings

Swivel Eye (800N) £P.O.A Angle Ball Joint (500N) £P.O.A Plain Stud Threads £P.O.A See Technical for dimensions of optional end fittings.
Clevis Fork (800N) £P.O.A Ball Socket (500N) £P.O.A Rod shrouds £P.O.A

Discounts: 10+ -5% 25+ -10% 50+ -15% 100+ -20%

Part Number	Stroke Extension	L	Max. Compression Force N	Mass Kg	Price Each 1 - 9
HB-15-25-AA-P	25	90	800	0.05	£104.46
HB-15-50-AA-P	50	140	800	0.06	£105.79
HB-15-75-AA-P	75	190	800	0.08	£107.36
HB-15-100-AA-P	100	240	350	0.10	£255.87
HB-15-150-AA-P	150	340	300	0.13	£259.25

Material

Body: Black powder coated Steel.

Piston Rod: Wear resistant ceramic coated Steel.

End Fittings: Zinc plated Steel.

Operating Temperature Range: -20°C to +80°C.

Operating Fluid: Hydraulic oil.

Free Travel: Approx. 20 % of stroke.

Positive mechanical stops 1 to 1.5mm before end of each stroke direction.

Options

P = Damping in both stroke directions (Standard)

M = Damping on out stroke only (Available on Request)

N = Damping on in stroke only (Available on Request)

These models provide damping effects either in one direction with free return, or both directions.

Special lengths, alternative seals and end fittings available, P.O.A.

'Eye' type end fitting supplied as standard, please refer to Technical for options.

End fittings are glued on as standard. If you require the end fittings to be separate, please add **-SEP** to the end of the part number.

Eg: **HB-15-25-AA-P-SEP**

Features

- Constant speed rates
- Bi-directional damping with precise control of speed in both directions of travel
- Easy mounting
- Long service life
- High quality
- As a safety device they prevent sudden movement.

Other Info.

Adjustment of the damping rate is achieved by pulling (or pushing) the piston rod to its fully extended (or compressed) position. Whilst still pulling the piston rod turn it clockwise to increase damping and anti-clockwise to decrease damping. If the resistance increases noticeably, stop adjusting to avoid damage. The adjustment can add a max. of 6 mm to the **L** dimension.

Mounting in any position, end fittings must be positively secured to prevent unscrewing. When used as a compensating feature on an application they smoothly dampen swinging loads.

When used with a 'drive actuator' these always ensure a uniform traverse speed.



+44 (0)1246 455500



+44 (0)1246 455522

ondrives

<https://amironic.co.uk/>



sales@ondrives.com



www.ondrives.com

Product information updated 11/2018. See <https://amironic.co.uk/> for the latest prices and availability.

ANTI-VIBRATION

HB-22

Adjustable Hydraulic Dampers

30N to 1,800N, 50 - 250mm Stroke

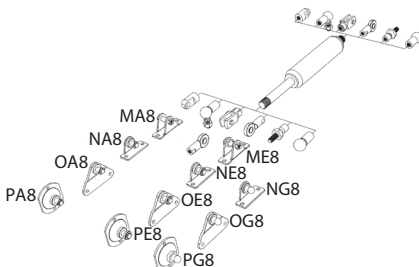

Optional Mounting Brackets

For Fixed Eyes: MA8 (1,800N) - £P.O.A

For Swivel Eyes: ME8 (1,800N) - £P.O.A

For Ball Sockets:

NA8 (1,000N) - £9.56

NE8 (1,000N) - £P.O.A

NG8 (1,000N) - £P.O.A

OA8 (1,200N) - £9.56

OE8 (1,200N) - £P.O.A

OG8 (1,200N) - £P.O.A

PA8 (1,200N) - £P.O.A

PE8 (1,200N) - £P.O.A

PG8 (1,200N) - £P.O.A

See Technical for dimensions of mounting brackets.

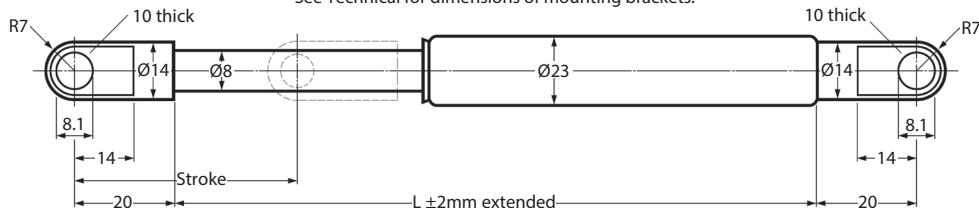

Optional End Fittings

Swivel Eye (3,000N)

Clevis Fork (3,000N)

£P.O.A Angle Ball Joint (1,200N)

£P.O.A Ball Socket (1,200N)

£P.O.A Plain Stud Threads

£P.O.A Rod shrouds

£P.O.A See Technical for dimensions

of optional end fittings.

Discounts: 10+ -5% 25+ -10% 50+ -15% 100+ -20%

Part Number	Stroke Extension	L	Max. Compression Force N	Mass Kg	Price Each 1 - 9
HB-22-50-AA-P	50	150	1,800	0.15	£116.86
HB-22-100-AA-P	100	250	1,800	0.22	£119.74
HB-22-150-AA-P	150	350	1,800	0.28	£121.09
HB-22-200-AA-P	200	450	1,000	0.36	£159.48
HB-22-250-AA-P	250	550	1,000	0.43	£176.19

Material

Body: Black powder coated Steel.

Piston Rod: Wear resistant ceramic coated Steel.

End Fittings: Zinc plated Steel.

Operating Temperature Range: -20°C to +80°C.

Operating Fluid: Hydraulic oil.

Free Travel: Approx. 20 % of stroke.

Positive mechanical stops 1 to 1.5mm before end of each stroke direction.

Options

P = Damping in both stroke directions (Standard)

M = Damping on out stroke only (Available on Request)

N = Damping on in stroke only (Available on Request)

These models provide damping effects either in one direction with free return, or both directions.

Special lengths, alternative seals and end fittings available, P.O.A.

'Eye' type end fitting supplied as standard, please refer to Technical for options.

End fittings are glued on as standard. If you require the end fittings to be separate, please add **-SEP** to the end of the part number.

Eg: HB-22-100-AA-P-SEP

Features

- Constant speed rates
- Bi-directional damping with precise control of speed in both directions of travel
- Easy mounting
- Long service life
- High quality
- As a safety device they prevent sudden movement.

Other Info.

Adjustment of the damping rate is achieved by pulling (or pushing) the piston rod to its fully extended (or compressed) position. Whilst still pulling the piston rod turn it clockwise to increase damping and anti-clockwise to decrease damping. If the resistance increases noticeably, stop adjusting to avoid damage. The adjustment can add a max. of 6 mm to the **L** dimension.

Mounting in any position, end fittings must be positively secured to prevent unscrewing. When used as a compensating feature on an application they smoothly dampen swinging loads.

When used with a "drive actuator" these always ensure a uniform traverse speed.



+44 (0)1246 455500



+44 (0)1246 455522

ondrives

<https://amironic.co.uk/>



sales@ondrives.com



www.ondrives.com

ANTI-VIBRATION

Adjustable Hydraulic Dampers

30N to 3,000N, 100 - 500mm Stroke

HB-28

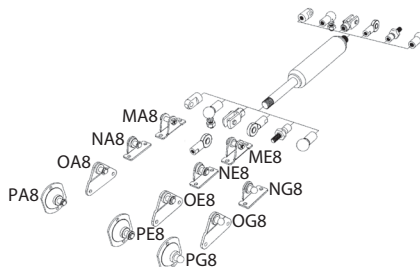

Optional Mounting Brackets

For Fixed Eyes: MA8 (1,800N) - £P.O.A

For Swivel Eyes: ME8 (1,800N) - £P.O.A

For Ball Sockets:

NA8 (1,000N) - £9.56

NE8 (1,000N) - £P.O.A

NG8 (1,000N) - £P.O.A

OA8 (1,200N) - £9.56

OE8 (1,200N) - £P.O.A

OG8 (1,200N) - £P.O.A

PA8 (1,200N) - £P.O.A

PE8 (1,200N) - £P.O.A

PG8 (1,200N) - £P.O.A

See Technical for dimensions of mounting brackets.

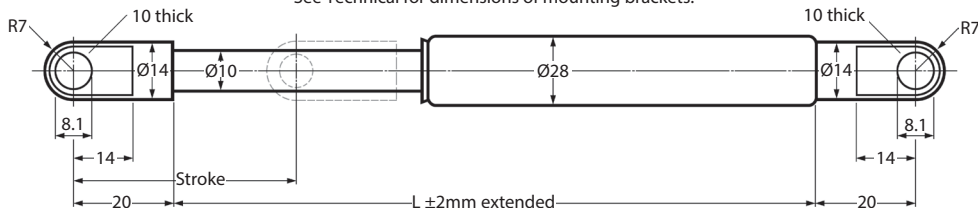

Optional End Fittings

Swivel Eye (3,000N)

Clevis Fork (3,000N)

£P.O.A Angle Ball Joint (1,200N)

£P.O.A Ball Socket (1,200N)

£P.O.A Plain Stud Threads

£P.O.A Rod shrouds

£P.O.A See Technical for dimensions of optional end fittings.

Discounts: 10+ -5% 25+ -10% 50+ -15% 100+ -20%

Part Number	Stroke Extension	L	Max. Compression Force N	Mass Kg	Price Each 1 - 9
HB-28-100-AA-P	100	260	3,000	0.38	£129.48
HB-28-150-AA-P	150	360	3,000	0.60	£132.13
HB-28-200-AA-P	200	460	3,000	0.62	£135.03
HB-28-250-AA-P	250	560	3,000	0.74	£176.92
HB-28-300-AA-P	300	660	2,500	0.84	£143.17
HB-28-350-AA-P	350	760	2,000	0.96	£151.62
HB-28-400-AA-P	400	860	1,500	1.10	£390.61
HB-28-500-AA-P	500	1,060	1,000	1.30	£425.14

Material

Body: Black powder coated Steel.

Piston Rod: Wear resistant ceramic coated Steel.

End Fittings: Zinc plated Steel.

Operating Temperature Range: -20°C to +80°C.

Operating Fluid: Hydraulic oil.

Free Travel: Approx. 20 % of stroke.

Positive mechanical stops 1 to 1.5mm before end of each stroke direction.

Options

P = Damping in both stroke directions (Standard)

M = Damping on out stroke only (Available on Request)

N = Damping on in stroke only (Available on Request)

These models provide damping effects either in one direction with free return, or both directions.

Special lengths, alternative seals and end fittings available, P.O.A.

'Eye' type end fitting supplied as standard, please refer to Technical for options.

End fittings are glued on as standard. If you require the end fittings to be separate, please add **-SEP** to the end of the part number.

Eg: **HB-28-200-AA-P-SEP**

Features

- Constant speed rates
- Bi-directional damping with precise control of speed in both directions of travel
- Easy mounting
- Long service life
- High quality
- As a safety device they prevent sudden movement.

Other Info.

Adjustment of the damping rate is achieved by pulling (or pushing) the piston rod to its fully extended (or compressed) position. Whilst still pulling the piston rod turn it clockwise to increase damping and anti-clockwise to decrease damping. If the resistance increases noticeably, stop adjusting to avoid damage. The adjustment can add a max. of 6 mm to the **L** dimension.

Mounting in any position, end fittings must be positively secured to prevent unscrewing. When used as a compensating feature on an application they smoothly dampen swinging loads.

When used with a 'drive actuator' these always ensure a uniform traverse speed.



+44 (0)1246 455500



+44 (0)1246 455522

ondrives

<https://amironic.co.uk/>



sales@ondrives.com



www.ondrives.com

Product information updated 15/05/2019. Please refer to our website for the latest prices and availability.

ANTI-VIBRATION

HB-40

Adjustable Hydraulic Dampers

30N to 10,000N, 100 - 800mm Stroke

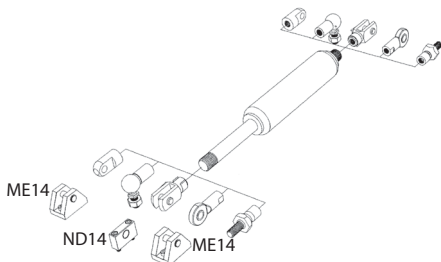

Optional Mounting Brackets

For Fixed & Swivel Eyes (10,000N): ME14 £P.O.A

For Clevis Forks (10,000N): ND14 £P.O.A

See page 693 for dimensions of mounting brackets.

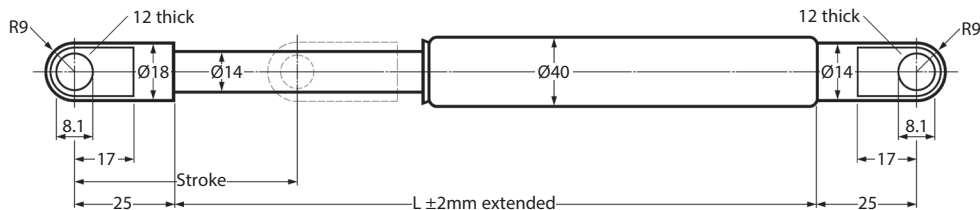

Optional End Fittings

Swivel Eye (10,000N)

£P.O.A Angle Ball Joint (3,200N) £P.O.A

Clevis Fork (10,000N)

£P.O.A

Plain Stud Threads

Rod shrouds

£P.O.A

£P.O.A

See Technical for dimensions of optional end fittings.

Discounts: 10+ -5% 25+ -10% 50+ -15% 100+ -20%

Part Number	Stroke Extension	L	Max. Compression Force N	Mass Kg	Price Each 1 - 9
HB-40-100-AA-P	100	275	10,000	0.80	£440.70
HB-40-150-AA-P	150	375	10,000	1.00	£452.08
HB-40-200-AA-P	200	475	10,000	1.18	£469.39
HB-40-300-AA-P	300	675	10,000	1.58	£498.18
HB-40-400-AA-P	400	875	8,000	1.96	£555.83
HB-40-500-AA-P	500	1,075	6,000	2.32	£P.O.A
HB-40-600-AA-P	600	1,275	4,000	2.70	£P.O.A
HB-40-700-AA-P	700	1,475	3,000	3.10	£P.O.A
HB-40-800-AA-P	800	1,675	3,000	3.80	£P.O.A

Material

Body: Black powder coated Steel.

Piston Rod: 303 Stainless Steel.

End Fittings: Zinc plated Steel.

Operating Temperature Range: -20°C to +80°C.

Operating Fluid: Hydraulic oil.

Free Travel: Approx. 21 % of stroke.

Positive mechanical stops 1 to 1.5mm before end of each stroke direction.

Options

P = Damping in both stroke directions (Standard)

M = Damping on out stroke only (Available on Request)

N = Damping on in stroke only (Available on Request)

These models provide damping effects either in one direction with free return, or both directions.

Special lengths, alternative seals and end fittings available, P.O.A.

'Eye' type end fitting supplied as standard, please refer to Technical for options.

End fittings are glued on as standard. If you require the end fittings to be separate, please add **-SEP** to the end of the part number.

Eg: **HB-40-200-AA-P-SEP**

Features

- Constant speed rates
- Bi-directional damping with precise control of speed in both directions of travel
- Easy mounting
- Individual filling by valve technology
- Calculation program for individual design
- Maintenance-free, self-contained, closed system unit.
- Long service life
- High quality
- As a safety device they prevent sudden movement.

Other Info.

Adjustment of the damping rate is handled, in the opposite way to the dampers HB-15 to HB-70, via the cylinder stud thread. The damping force can be precisely regulated by using a screwdriver. Adjusted at the end of stroke.

Mounting in any position, end fittings must be positively secured to prevent unscrewing. When used as a compensating feature on an application they smoothly dampen swinging loads.

When used with a "drive actuator" these always ensure a uniform traverse speed.



+44 (0)1246 455500



+44 (0)1246 455522

ondrives

<https://amironic.co.il/>



sales@ondrives.com



www.ondrives.com

ANTI-VIBRATION

Adjustable Hydraulic Dampers

2,000N to 50,000N, 100 - 800mm Stroke

HB-70

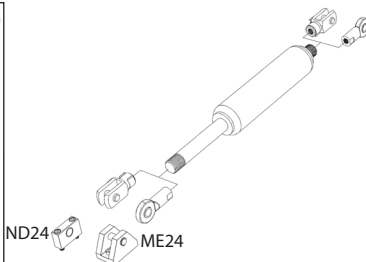

Swivel Eye

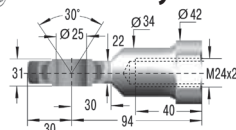

Clevis Fork

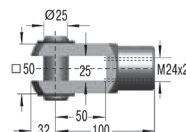

Optional Mounting Brackets

For Swivel Eyes (50,000N): ME24

For Clevis Forks (50,000N): ND24

£P.O.A

£P.O.A

See page 693 for dimensions of mounting brackets.

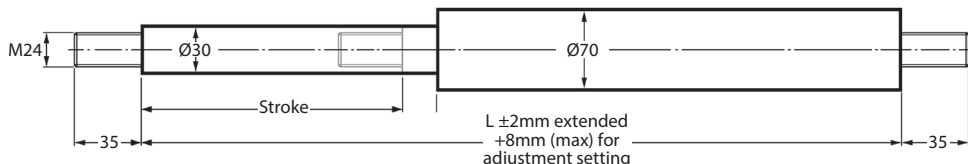

Stud Thread

Fitted as standard

Optional End Fittings

Swivel Eye (50,000N)

Clevis Fork (50,000N)

Rod shrouds

£P.O.A

£P.O.A

£P.O.A

See above for dimensions of optional end fittings.

Discounts: 10+ -5% 25+ -10% 50+ -15% 100+ -20%

Part Number	Stroke Extension	L	Max. Compression Force N	Mass Kg	Price Each 1 - 9
HB-70-100-EE-P	100	320	50,000	6.40	£P.O.A
HB-70-200-EE-P	200	520	50,000	8.20	£P.O.A
HB-70-300-EE-P	300	720	50,000	10.00	£P.O.A
HB-70-400-EE-P	400	920	30,300	11.80	£P.O.A
HB-70-500-EE-P	500	1,120	21,600	13.60	£P.O.A
HB-70-600-EE-P	600	1,320	16,200	15.40	£P.O.A
HB-70-700-EE-P	700	1,520	12,600	17.20	£P.O.A
HB-70-800-EE-P	800	1,720	10,100	19.00	£P.O.A

Material

Body: Black powder coated Steel.

Piston Rod: Wear resistant ceramic coated Steel.

End Fittings: Zinc plated Steel.

(Stud threads supplied as standard, see above for options).

Operating Temperature Range: -20°C to +80°C.

Operating Fluid: Hydraulic oil.

Free Travel: Approx. 20 % of stroke.

Positive mechanical stops 1 to 1.5mm before end of each stroke direction.

Options

P = Damping in both stroke directions (Standard)

M = Damping on out stroke only (Available on Request)

N = Damping on in stroke only (Available on Request)

These models provide damping effects either in one direction with free return, or both directions.

Special lengths, alternative seals and end fittings available, P.O.A.

Features

- Constant speed rates
- Bi-directional damping with precise control of speed in both directions of travel
- Easy mounting
- Long service life
- High quality
- As a safety device they prevent sudden movement.

Other Info.

Adjustment of the damping rate is achieved by pulling (or pushing) the piston rod to its fully extended (or compressed) position. Whilst still pulling the piston rod turn it clockwise to increase damping and anti-clockwise to decrease damping. If the resistance increases noticeably, stop adjusting to avoid damage. The adjustment can add a max. of 6 mm to the L dimension.

Mounting in any position, end fittings must be positively secured to prevent unscrewing. When used as a compensating feature on an application they smoothly dampen swinging loads.

When used with a "drive actuator" these always ensure a uniform traverse speed.



+44 (0)1246 455500



+44 (0)1246 455522

ondrives

<https://amironic.co.il/>



sales@ondrives.com



www.ondrives.com

Product information updated 12/2019. See our website for the latest prices and availability.

ANTI-VIBRATION

Adjustable Hydraulic Dampers

TECHNICAL

Adjustable linear hydraulic dampers are self-contained devices, designed to provide an adjustable controlled velocity over long stroke lengths, with virtually no maintenance.

Despite their similar appearance to gas springs, HB dampers are not pressurised and do not provide any return force of their own. They are filled with hydraulic oil and provide a fully adjustable controlled feed rate when a load is applied to them.

Four standard models are available with stroke lengths from 25mm to 800mm and are all available with interchangeable end fittings and mounting brackets. Resisting forces are internally adjustable and give a very wide adjustment range. The HB15 can operate with a minimum resistance of only 20N whilst the largest model the HB40 can control a load with a maximum resistance force of 10,000N.

All models can control the velocity for either the "out stroke" (available on request), the "in stroke" (available on request), or in both directions (standard feature).

Typical applications for HB dampers are pneumatic cylinders, machine guards, vat lids, safety fire flaps and doors, damping oscillations of suspended loads, smoke and roof vents, equipment hoods, etc.

Technical Data

Adjustment of the damping rate is achieved by pulling (or pushing) the piston rod to its fully extended (or fully compressed) position. Whilst still pulling the piston rod, turn it clockwise to increase damping or anti-clockwise to decrease damping. The adjustment is multi-turn and to achieve the correct damping speed may require several trial and error adjustments.

This adjustment can add a maximum of 6mm to the L dimension.

Free Travel: Construction method of standard damper results in a free travel of approximately 20% of total stroke when changing travel direction.

Mechanical Stops: Provide positive stops 1 to 1.5mm before end of each stroke direction.

Mounting Position: Can be mounted in any position.

Operating Temperature Range: -30°C to +80°C (with special seals up to +120°C)

Operating Fluid: Hydraulic oil.

Compression and Extension Damping Forces: 20N to 10,000N. On long strokes observe the limits on the maximum compression force to avoid buckling.

End Fittings

HB-12 to HB-40 Dampers are supplied with 'eye' end fittings on both the piston rod and body as **standard**.

Alternative end fittings are available on request, P.O.A. (see diagram below).

Damping Options

P = Damping in both stroke directions (Standard)

M = Damping on out stroke only (Available on Request)

N = Damping on in stroke only (Available on Request)

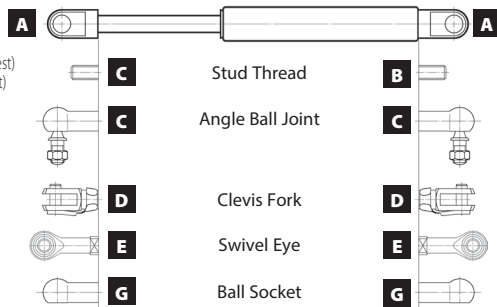

Ordering Example:

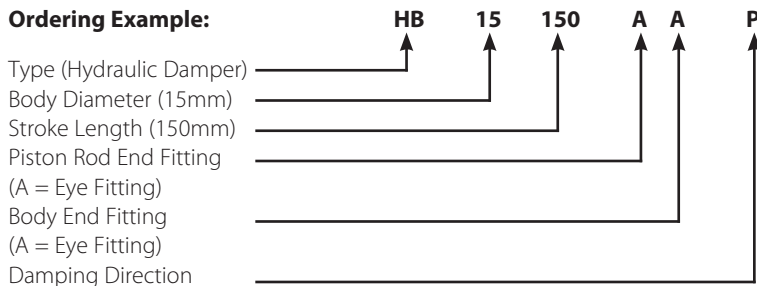

+44 (0)1246 455500



+44 (0)1246 455522

ondrives

<https://amironic.co.uk/>



sales@ondrives.com

www.ondrives.com

ANTI-VIBRATION

Adjustable Gas Springs & Hydraulic Dampers

Optional End Fittings

Fixed Eye

GSA8 to 12, HB-12

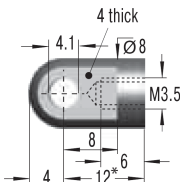

* 11 (Stainless)

GSA15, HB-15

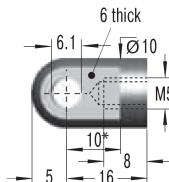

* 9 (Stainless)

GSA19 to 22, HB-22 to 28

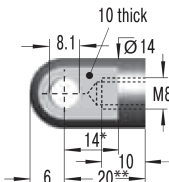

* 11.5, ** 19 (Stainless)

GSA28

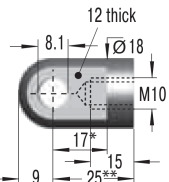

* 15, ** 27 (Stainless)

GSA40, HB-40

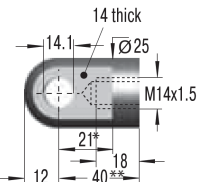

* 19.5, ** 42 (Stainless)

Swivel Eye

GSA8 to 12, HB-12

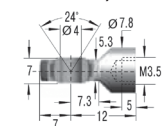

Available in Steel only

GSA15, HB-15

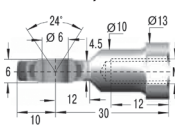

GSA19 to 22, HB-22 to 28

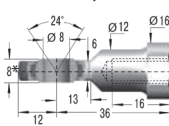

* 12 (Stainless)

GSA28

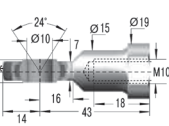

* 14 (Stainless)

GSA40, HB-40

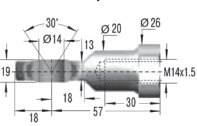

Clevis Fork

GSA8 to 12, HB-12

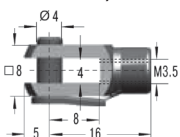

GSA15, HB-15

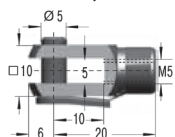

GSA19 to 22, HB-22 to 28

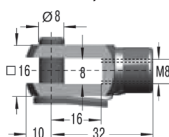

GSA28

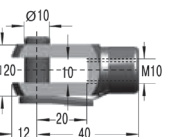

GSA40, HB-40

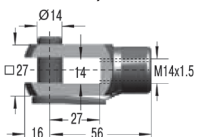

Angle Ball Joint

GSA8 to 12, HB-12

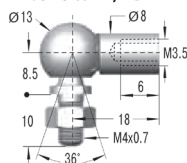

GSA15, HB-15

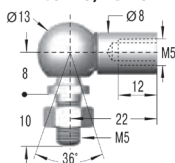

GSA19 to 22, HB-22 to 28

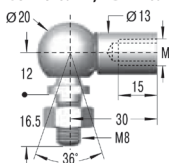

GSA28

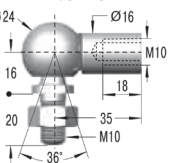

GSA40, HB-40

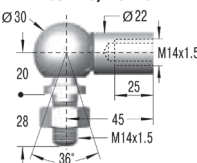

Ball Socket

GSA8 to 12, HB-12

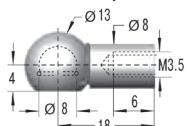

GSA15, HB-15

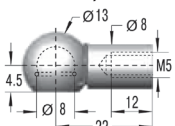

GSA19 to 22, HB-22 to 28

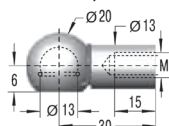

Inline Ball Joint

GSA15

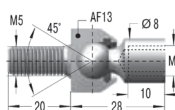

Available in Steel only

GSA19 & GSA22

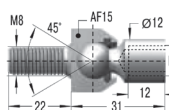

Available in Steel only

GSA28

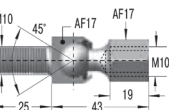

Available in Steel only

GSA40

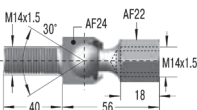

Available in Steel only

For GSA8-V4A to GSA12-V4A Gas Springs, add -V4A suffix for Stainless Steel end fittings.

For GSA15-V4A to GSA40-V4A Gas Springs, add -VA suffix for Stainless Steel end fittings.



+44 (0)1246 455500



+44 (0)1246 455522

ondrives

<https://amironic.co.il/>



sales@ondrives.com



www.ondrives.com

Product information updated 11/2024. Prices and availability subject to change without notice. Sales for the latest prices and availability.

ANTI-VIBRATION

Adjustable Gas Springs & Hydraulic Dampers

Optional Mounting Brackets

GSA8 to 12, HB-12

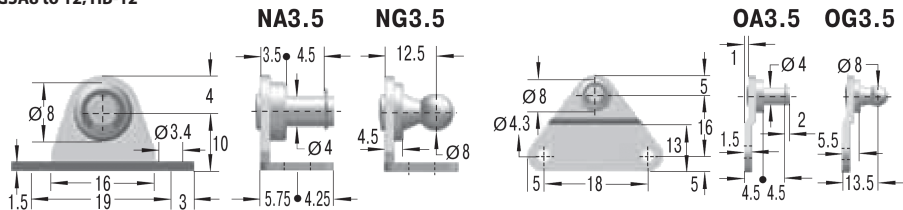

GSA15, HB-15

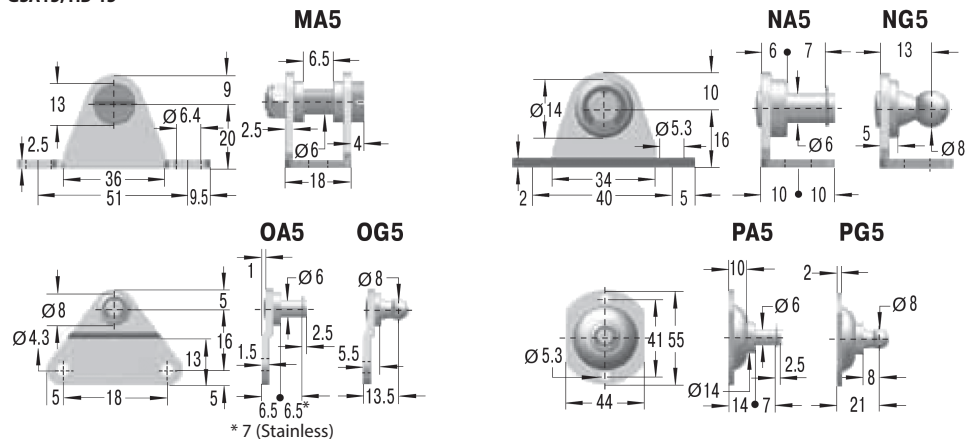

GSA19 to 22, HB-22 to 28

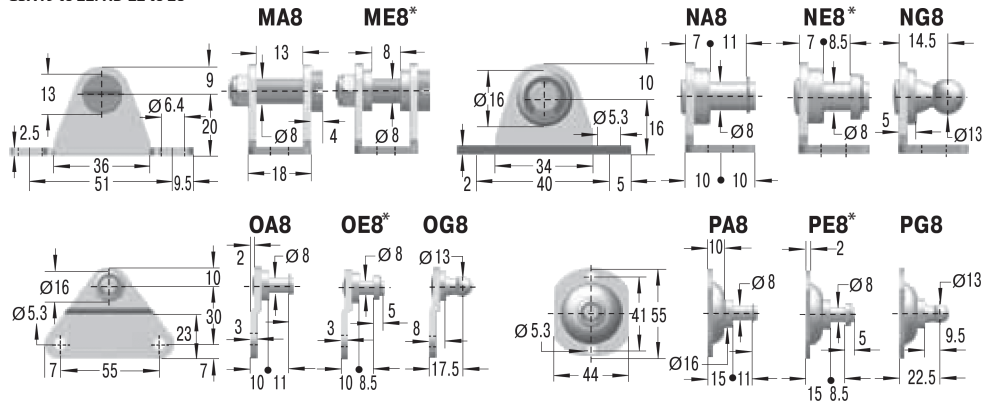

* ME8, NE8, OE8 & PE8 are available in Steel only,

For GSA8-V4A to GSA28-VA Gas Springs, add -V4A suffix for Stainless Steel mounting brackets (where available).

For GSA40-VA Gas Springs, add -VA suffix for Stainless Steel mounting brackets (where available).



+44 (0)1246 455500



+44 (0)1246 455522

ondrives



sales@ondrives.com



www.ondrives.com

Adjustable Gas Springs & Hydraulic Dampers

Optional Mounting Brackets

GSA28

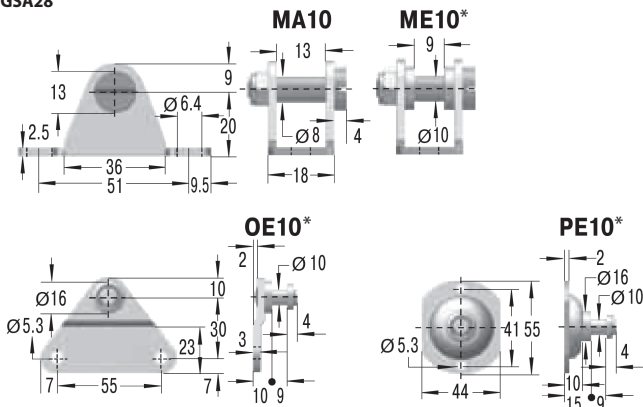

* ME10, OE10 & PE10 are available in Steel only.

GSA40, HB-40

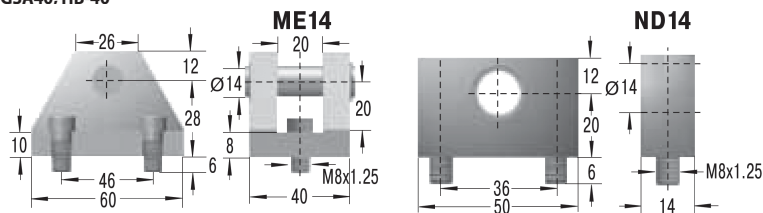

GSA70, HB-70

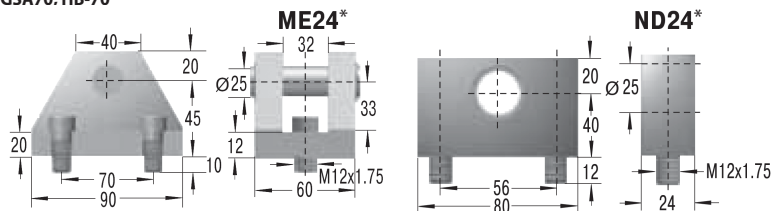

* ME24 & ND24 are available in Steel only,

For GSA8-V4A to GSA28-VA Gas Springs, add -V4A suffix for Stainless Steel mounting brackets (where available).

For GSA40-VA Gas Springs, add -VA suffix for Stainless Steel mounting brackets (where available).



+44 (0)1246 455500



+44 (0)1246 455522

ondrives



sales@ondrives.com

www.ondrives.com

<https://amironic.co.il/>

<https://amironic.co.il/>