



AMIRONIC

AMIRONIC.CO.IL

Anti-backlash Wormwheels

Pages 16.2 – 16.15

TECHNICAL

Pages 27.54 – 27.60



For non-standard Antibacklash Wormwheels use form on opposite page or send a drawing or sample for a free, no-obligation quote.

<https://amironic.co.il/>



16.1

Anti-backlash Wormwheels *Materials*

0.4 MOD

STD : Phosphor Bronze PB2
SPECIAL TEETH : between 60 - 300

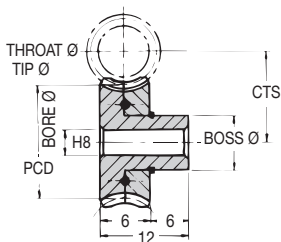

20° Pressure Angle

TORQUE CHECK variations at back	50 TEETH x 1000 R.P.M. INPUT
	with std worm
TORQUE Nm	0.056
K.W.	0.0012

DISCOUNTS

Quantity	List Price
1 - 5	
6 - 19	- 12%
20 - 39	- 25%
40 - 59	- 33%
60 - 99	- 37%
100 - 200	- 42%

Anti-backlash Wormwheels

MOD 0.4

PART NUMBER	TEETH	PCD (mm)	CTS (mm)	THROAT Ø (mm)	TIP Ø (mm)	BOSS Ø (mm)	BORE Ø (mm)	PRICE EACH 1-5
ABM0.4-60	60	24.00	16.50	24.80	25.20	12	4	£42.27
ABM0.4-62	62	24.80	16.90	25.60	26.00	12	4	£42.81
ABM0.4-64	64	25.60	17.30	26.40	26.80	12	4	£43.30
ABM0.4-68	68	27.20	18.10	28.00	28.40	12	4	£44.35
ABM0.4-70	70	28.00	18.50	28.80	29.20	12	4	£44.88
ABM0.4-72	72	28.80	18.90	29.60	30.00	12	5	£45.43
ABM0.4-75	75	30.00	19.50	30.80	31.20	12	5	£45.92
ABM0.4-76	76	30.40	19.70	31.20	31.60	12	5	£46.48
ABM0.4-80	80	32.00	20.50	32.80	33.20	12	5	£46.91
ABM0.4-84	84	33.60	21.30	34.40	34.80	12	5	£47.98
ABM0.4-85	85	34.00	21.50	34.80	35.20	12	5	£49.05
ABM0.4-86	86	34.40	21.70	35.20	35.60	12	5	£50.15
ABM0.4-90	90	36.00	22.50	36.80	37.20	12	5	£51.23
ABM0.4-92	92	36.80	22.90	37.60	38.00	12	5	£52.29
ABM0.4-94	94	37.60	23.30	38.40	38.80	12	5	£53.38
ABM0.4-96	96	38.40	23.70	39.20	39.60	12	5	£54.41
ABM0.4-100	100	40.00	24.50	40.80	41.20	12	5	£55.47
ABM0.4-110	110	44.00	26.50	44.80	45.20	12	5	£61.22
ABM0.4-120	120	48.00	28.50	48.80	49.20	12	5	£67.31
ABM0.4-130	130	52.00	30.50	52.80	53.20	12	5	£78.25
ABM0.4-140	140	56.00	32.50	56.80	57.20	12	5	£85.69
ABM0.4-150	150	60.00	34.50	60.80	61.20	20	5	£91.87
ABM0.4-200	200	80.00	44.50	80.80	81.20	20	6	£123.00
ABM0.4-300	300	120.00	64.50	120.80	121.20	20	6	£143.15



Materials **Anti-backlash Wormwheels**

STD : Phosphor Bronze PB2

SPECIAL TEETH : between 50 - 160

0.5 MOD

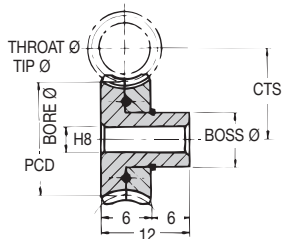

DISCOUNTS

1 - 5	List Price
6 - 19	- 12%
20 - 39	- 25%
40 - 59	- 33%
60 - 99	- 37%
100 - 200	- 42%

TORQUE CHECK	50 TEETH x 1000 R.P.M. INPUT
variations at back	with std worm
TORQUE Nm	0.10
K.W.	0.0002

20° Pressure Angle

Anti-backlash

PART NUMBER	TEETH	PCD (mm)	CTS (mm)	THROAT Ø (mm)	TIP Ø (mm)	BOSS Ø (mm)	BORE Ø (mm)	PRICE EACH 1-5
ABM0.5-50	50	25.00	18.50	26.00	26.50	13	6	£43.30
ABM0.5-52	52	26.00	19.00	27.00	27.50	13	6	£43.98
ABM0.5-55	55	27.50	19.75	28.50	29.00	13	6	£44.67
ABM0.5-58	58	29.00	20.50	30.00	30.50	13	6	£45.36
ABM0.5-60	60	30.00	21.00	31.00	31.50	13	6	£46.05
ABM0.5-62	62	31.00	21.50	32.00	32.50	13	6	£46.69
ABM0.5-65	65	32.50	22.25	33.50	34.00	13	6	£47.44
ABM0.5-68	68	34.00	23.00	35.00	35.50	13	6	£47.98
ABM0.5-70	70	35.00	23.50	36.00	36.50	13	6	£49.00
ABM0.5-72	72	36.00	24.00	37.00	37.50	13	6	£50.10
ABM0.5-75	75	37.50	24.75	38.50	39.00	13	6	£51.10
ABM0.5-78	78	39.00	25.50	40.00	40.50	13	6	£52.15
ABM0.5-80	80	40.00	26.00	41.00	41.50	13	6	£53.20
ABM0.5-82	82	41.00	26.50	42.00	42.50	13	6	£53.94
ABM0.5-85	85	42.50	27.25	43.50	44.00	13	6	£54.70
ABM0.5-88	88	44.00	28.00	45.00	45.50	13	6	£55.42
ABM0.5-90	90	45.00	28.50	46.00	46.50	13	6	£56.12
ABM0.5-92	92	46.00	29.00	47.00	47.50	13	6	£56.83
ABM0.5-95	95	47.50	29.75	48.50	49.00	13	6	£57.57
ABM0.5-96	96	48.00	30.00	49.00	49.50	13	6	£58.26
ABM0.5-98	98	49.00	30.50	50.00	50.50	13	6	£58.95
ABM0.5-100	100	50.00	31.00	51.00	51.50	13	6	£59.86
ABM0.5-110	110	55.00	33.50	56.00	56.50	13	6	£72.73
ABM0.5-120	120	60.00	36.00	61.00	61.50	13	6	£79.61
ABM0.5-140	140	70.00	41.00	71.00	71.50	13	6	£86.47
ABM0.5-150	150	75.00	43.50	76.00	76.50	13	6	£91.26
ABM0.5-160	160	80.00	46.00	81.00	81.50	13	6	£96.09

Wormwheels MOD 0.5



Anti-backlash Wormwheels Materials

0.8 MOD

STD : Phosphor Bronze PB2
SPECIAL TEETH : between 48 - 150

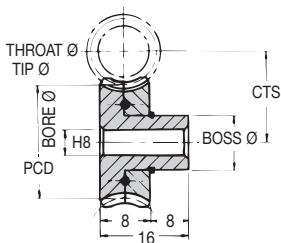

20° Pressure Angle

TORQUE CHECK variations at back	50 TEETH x 1000 R.P.M. INPUT
	with std worm
TORQUE Nm	0.28
K.W.	0.0006

DISCOUNTS

Quantity	List Price
1 - 5	-
6 - 19	- 12%
20 - 39	- 25%
40 - 59	- 33%
60 - 99	- 37%
100 - 200	- 42%

Anti-backlash Wormwheels MOD 0.8

PART NUMBER	TEETH	PCD mm	CTS mm	THROAT Ø mm	TIP Ø mm	BOSS Ø mm	BORE Ø mm	PRICE EACH 1-5
ABM0.8-48	48	38.40	25.20	40.00	40.80	20	8	£57.26
ABM0.8-50	50	40.00	26.00	41.60	42.40	20	8	£59.49
ABM0.8-52	52	41.60	26.80	43.20	44.00	20	8	£61.72
ABM0.8-54	54	43.20	27.60	44.80	45.60	20	8	£63.91
ABM0.8-55	55	44.00	28.00	45.60	46.40	20	8	£66.12
ABM0.8-58	58	46.40	29.20	48.00	48.80	20	8	£68.34
ABM0.8-60	60	48.00	30.00	49.60	50.40	20	8	£70.57
ABM0.8-62	62	49.60	30.80	51.20	52.00	20	8	£72.73
ABM0.8-64	64	51.20	31.60	52.80	53.60	20	8	£76.12
ABM0.8-65	65	52.00	32.00	53.60	54.40	20	8	£79.52
ABM0.8-68	68	54.40	33.20	56.00	56.80	20	8	£82.87
ABM0.8-70	70	56.00	34.00	57.60	58.40	20	8	£86.23
ABM0.8-72	72	57.60	34.80	59.20	60.00	20	8	£89.65
ABM0.8-75	75	60.00	36.00	61.60	62.40	20	8	£92.98
ABM0.8-78	78	62.40	37.20	64.00	64.80	20	8	£95.39
ABM0.8-80	80	64.00	38.00	65.60	66.40	20	8	£97.92
ABM0.8-82	82	65.60	38.80	67.20	68.00	20	8	£100.38
ABM0.8-85	85	68.00	40.00	69.60	70.40	20	8	£102.83
ABM0.8-88	88	70.40	41.20	72.00	72.80	20	8	£105.31
ABM0.8-90	90	72.00	42.00	73.60	74.40	20	8	£107.74
ABM0.8-94	94	75.20	43.60	76.80	77.60	20	8	£110.25
ABM0.8-96	96	76.80	44.40	78.40	79.20	20	8	£112.74
ABM0.8-100	100	80.00	46.00	81.60	82.40	20	8	£117.45
ABM0.8-110	110	88.00	50.00	89.60	90.40	20	8	£122.15
ABM0.8-120	120	96.00	54.00	97.60	98.40	20	8	£126.87
ABM0.8-150	150	120.00	66.00	121.60	122.40	20	8	£153.14

16.4



<https://amironic.co.il/>

Materials **Anti-backlash Wormwheels**

STD : Phosphor Bronze PB2

SPECIAL TEETH : between 48 - 150

1 MOD

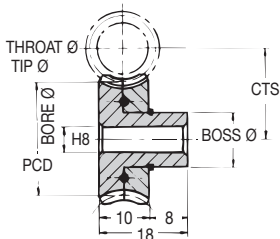

DISCOUNTS

1 - 5	List Price
6 - 19	- 12%
20 - 39	- 25%
40 - 59	- 33%
60 - 99	- 37%
100 - 200	- 42%

TORQUE CHECK variations at back	50 TEETH x 1000 R.P.M. INPUT with std worm
TORQUE Nm	0.584
K.W.	0.0012

20° Pressure Angle

Anti-backlash

PART NUMBER	TEETH	PCD mm	CTS mm	THROAT Ø mm	TIP Ø mm	BOSS Ø mm	BORE Ø mm	PRICE EACH 1-5
ABM1-48	48	48	31.50	50	51	25	10	£84.56
ABM1-50	50	50	32.50	52	53	25	10	£87.80
ABM1-52	52	52	33.50	54	55	25	10	£91.04
ABM1-54	54	54	34.50	56	57	25	10	£94.23
ABM1-55	55	55	35.00	57	58	25	10	£97.42
ABM1-58	58	58	36.50	60	61	25	10	£100.69
ABM1-60	60	60	37.50	62	63	25	10	£103.90
ABM1-62	62	62	38.50	64	65	25	10	£107.92
ABM1-64	64	64	39.50	66	67	25	10	£111.94
ABM1-65	65	65	40.00	67	68	25	10	£115.97
ABM1-68	68	68	41.50	70	71	25	10	£119.99
ABM1-70	70	70	42.50	72	73	25	10	£124.01
ABM1-72	72	72	43.50	74	75	25	10	£127.95
ABM1-75	75	75	45.00	77	78	25	10	£131.76
ABM1-78	78	78	46.50	80	81	25	10	£135.55
ABM1-80	80	80	47.50	82	83	25	10	£139.33
ABM1-82	82	82	48.50	84	85	25	10	£143.15
ABM1-85	85	85	50.00	87	88	25	10	£146.93
ABM1-88	88	88	51.50	90	91	25	10	£150.79
ABM1-90	90	90	52.50	92	93	25	10	£154.51
ABM1-94	94	94	54.50	96	97	25	10	£161.82
ABM1-96	96	96	55.50	98	99	25	10	£169.12
ABM1-100	100	100	57.50	102	103	25	10	£176.46
ABM1-110	110	110	62.50	112	113	30	10	£220.99
ABM1-120	120	120	67.50	122	123	30	10	£265.50
ABM1-150	150	150	82.50	152	153	30	10	£370.30

Wormwheels MOD 1



Anti-backlash Wormwheels Materials

1.25 MOD

STD : Phosphor Bronze PB2
SPECIAL TEETH : between 45 - 120

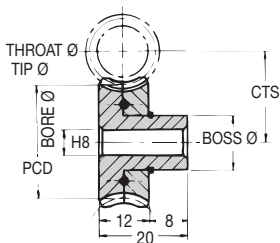

20° Pressure Angle

TORQUE CHECK	50 TEETH x 1000 R.P.M. INPUT
variations at back	with std worm
TORQUE Nm	1.14
K.W.	0.024

DISCOUNTS

Quantity	List Price
1 - 5	-
6 - 19	- 12%
20 - 39	- 25%
40 - 59	- 33%
60 - 99	- 37%
100 - 200	- 42%

Anti-backlash Wormwheels

MOD 1.25

PART NUMBER	TEETH	PCD (mm)	CTS (mm)	THROAT Ø (mm)	TIP Ø (mm)	BOSS Ø (mm)	BORE Ø (mm)	PRICE EACH 1-5
ABM1.25-45	45	56.25	36.13	58.75	60.00	25	10	£95.59
ABM1.25-48	48	60.00	38.00	62.50	63.75	25	10	£100.31
ABM1.25-50	50	62.50	39.25	65.00	66.25	25	10	£107.00
ABM1.25-52	52	65.00	40.50	67.50	68.75	32	12	£109.79
ABM1.25-54	54	67.50	41.75	70.00	71.25	32	12	£114.53
ABM1.25-55	55	68.75	42.38	71.25	72.50	32	12	£119.29
ABM1.25-58	58	72.50	44.25	75.00	76.25	32	12	£124.01
ABM1.25-60	60	75.00	45.50	77.50	78.75	32	12	£128.84
ABM1.25-62	62	77.50	46.75	80.00	81.25	32	12	£133.73
ABM1.25-64	64	80.00	48.00	82.50	83.75	32	12	£138.61
ABM1.25-65	65	81.25	48.63	83.75	85.00	32	12	£143.53
ABM1.25-68	68	85.00	50.50	87.50	88.75	32	12	£151.20
ABM1.25-70	70	87.50	51.75	90.00	91.25	32	12	£153.38
ABM1.25-72	72	90.00	53.00	92.50	93.75	32	12	£158.15
ABM1.25-74	74	92.50	54.25	95.00	96.25	32	12	£162.96
ABM1.25-75	75	93.75	54.88	96.25	97.50	32	12	£167.72
ABM1.25-78	78	97.50	56.75	100.00	101.25	32	12	£172.50
ABM1.25-80	80	100.00	58.00	102.50	103.75	32	12	£177.29
ABM1.25-82	82	102.50	59.25	105.00	106.25	32	12	£196.75
ABM1.25-85	85	106.25	61.13	108.75	110.00	32	12	£216.14
ABM1.25-88	88	110.00	63.00	112.50	113.75	32	12	£235.56
ABM1.25-90	90	112.50	64.25	115.00	116.25	32	12	£254.99
ABM1.25-95	95	118.75	67.38	121.25	122.50	50	12	£274.47
ABM1.25-98	98	122.50	69.25	125.00	126.25	50	12	£293.90
ABM1.25-100	100	125.00	70.50	127.50	128.75	50	12	£313.37
ABM1.25-110	110	137.50	76.75	140.00	141.25	50	12	£364.26
ABM1.25-120	120	150.00	83.00	152.50	153.75	50	12	£415.13



Materials **Anti-backlash Wormwheels**

STD : Phosphor Bronze PB2

SPECIAL TEETH : between 40 - 95

1.5 MOD

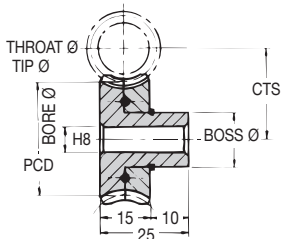

DISCOUNTS

1 - 5	List Price
6 - 19	- 12%
20 - 39	- 25%
40 - 59	- 33%
60 - 99	- 37%
100 - 200	- 42%

TORQUE CHECK	50 TEETH x 1000 R.P.M. INPUT
variations at back	with std worm
TORQUE Nm	1.74
K.W.	0.0034

20° Pressure Angle

Anti-backlash

PART NUMBER	TEETH	PCD (mm)	CTS (mm)	THROAT Ø (mm)	TIP Ø (mm)	BOSS Ø (mm)	BORE Ø (mm)	PRICE EACH 1-5
ABM1.5-40	40	60.00	40.00	63.00	64.50	30	15	£104.47
ABM1.5-42	42	63.00	41.50	66.00	67.50	30	15	£119.04
ABM1.5-44	44	66.00	43.00	69.00	70.50	30	15	£133.60
ABM1.5-45	45	67.50	43.75	70.50	72.00	30	15	£148.19
ABM1.5-48	48	72.00	46.00	75.00	76.50	30	15	£162.69
ABM1.5-50	50	75.00	47.50	78.00	79.50	30	15	£177.27
ABM1.5-52	52	78.00	49.00	81.00	82.50	30	15	£191.83
ABM1.5-54	54	81.00	50.50	84.00	85.50	30	15	£206.38
ABM1.5-55	55	82.50	51.25	85.50	87.00	30	15	£215.56
ABM1.5-58	58	87.00	53.50	90.00	91.50	30	15	£224.78
ABM1.5-60	60	90.00	55.00	93.00	94.50	30	15	£233.97
ABM1.5-62	62	93.00	56.50	96.00	97.50	30	15	£243.15
ABM1.5-64	64	96.00	58.00	99.00	100.50	30	15	£252.36
ABM1.5-65	65	97.50	58.75	100.50	102.00	30	15	£261.47
ABM1.5-68	68	102.00	61.00	105.00	106.50	30	15	£279.21
ABM1.5-70	70	105.00	62.50	108.00	109.50	30	15	£296.83
ABM1.5-72	72	108.00	64.00	111.00	112.50	30	15	£314.18
ABM1.5-74	74	111.00	65.50	114.00	115.50	30	15	£332.41
ABM1.5-75	75	112.50	66.25	115.50	117.00	30	15	£350.11
ABM1.5-78	78	117.00	68.50	120.00	121.50	30	15	£367.87
ABM1.5-80	80	120.00	70.00	123.00	124.50	30	15	£385.63
ABM1.5-82	82	123.00	71.50	126.00	127.50	30	15	£409.47
ABM1.5-85	85	127.50	73.75	130.50	132.00	30	15	£429.37
ABM1.5-88	88	132.00	76.00	135.00	136.50	30	15	£451.26
ABM1.5-90	90	135.00	77.50	138.00	139.50	30	15	£473.12
ABM1.5-92	92	138.00	79.00	141.00	142.50	30	15	£494.97
ABM1.5-95	95	142.50	81.25	145.50	147.00	30	15	£516.90

Wormwheels MOD 1.5



Anti-backlash Wormwheels *Materials*

2 MOD

STD : Phosphor Bronze PB2
SPECIAL TEETH : between 40 - 80

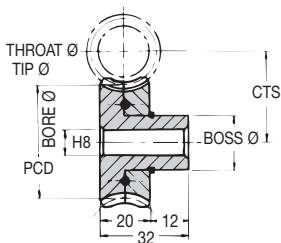

20° Pressure Angle

TORQUE CHECK	50 TEETH x 1000 R.P.M. INPUT
variations at back	with std worm
TORQUE Nm	4.50
K.W.	0.0094

DISCOUNTS

Quantity	List Price
1 - 5	-
6 - 19	- 12%
20 - 39	- 25%
40 - 59	- 33%
60 - 99	- 37%
100 - 200	- 42%

Anti-backlash Wormwheels

MOD 2

PART NUMBER	TEETH	PCD (mm)	CTS (mm)	THROAT Ø (mm)	TIP Ø (mm)	BOSS Ø (mm)	BORE Ø (mm)	PRICE EACH 1-5
ABM2-40	40	80	52.50	84	86	50	20	£168.68
ABM2-42	42	84	54.50	88	90	50	20	£192.03
ABM2-44	44	88	56.50	92	94	50	20	£215.45
ABM2-45	45	90	57.50	94	96	50	20	£238.84
ABM2-46	46	92	58.50	96	98	50	20	£262.24
ABM2-48	48	96	60.50	100	102	50	20	£285.63
ABM2-50	50	100	62.50	104	106	50	20	£298.80
ABM2-52	52	104	64.50	108	110	50	20	£311.92
ABM2-54	54	108	66.50	112	114	50	20	£325.10
ABM2-55	55	110	67.50	114	116	50	20	£338.25
ABM2-56	56	112	68.50	116	118	50	20	£351.40
ABM2-58	58	116	70.50	120	122	50	20	£366.04
ABM2-60	60	120	72.50	124	126	50	20	£380.70
ABM2-62	62	124	74.50	128	130	50	20	£395.33
ABM2-64	64	128	76.50	132	134	50	20	£410.02
ABM2-65	65	130	77.50	134	136	50	20	£424.67
ABM2-66	66	132	78.50	136	138	50	20	£439.29
ABM2-68	68	136	80.50	140	142	50	20	£453.96
ABM2-70	70	140	82.50	144	146	50	20	£476.43
ABM2-72	72	144	84.50	148	150	50	20	£498.91
ABM2-74	74	148	86.50	152	154	50	20	£521.38
ABM2-75	75	150	87.50	154	156	50	20	£543.90
ABM2-76	76	152	88.50	156	158	50	20	£566.34
ABM2-78	78	156	90.50	160	162	50	20	£588.82
ABM2-80	80	160	92.50	164	166	50	20	£611.26



Materials **Anti-backlash Wormwheels**

STD : Phosphor Bronze PB2

SPECIAL TEETH : between 60 - 300

64 DP

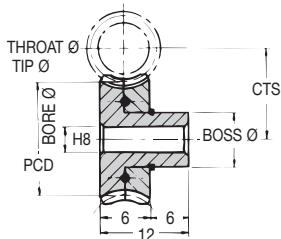

DISCOUNTS

1 - 5	List Price
6 - 19	- 12%
20 - 39	- 25%
40 - 59	- 33%
60 - 99	- 37%
100 - 200	- 42%

TORQUE CHECK	50 TEETH x 1000 R.P.M. INPUT
variations at back	with std worm
TORQUE Nm	0.056
K.W.	0.0012

20° Pressure Angle

PART NUMBER	TEETH	PCD (ins)	CTS (ins)	THROAT Ø (ins)	TIP Ø (ins)	BOSS Ø (ins)	BORE Ø (ins)	PRICE EACH 1-5
ABM64-60	60	0.938	0.656	0.969	0.984	0.500	0.187	£42.27
ABM64-62	62	0.969	0.672	1.000	1.016	0.500	0.187	£42.81
ABM64-64	64	1.000	0.688	1.031	1.047	0.500	0.187	£43.30
ABM64-68	68	1.063	0.719	1.094	1.109	0.500	0.187	£43.86
ABM64-70	70	1.094	0.734	1.125	1.141	0.500	0.187	£44.35
ABM64-72	72	1.125	0.750	1.156	1.172	0.500	0.187	£44.88
ABM64-75	75	1.172	0.773	1.203	1.219	0.500	0.187	£45.43
ABM64-76	76	1.188	0.781	1.219	1.234	0.500	0.187	£45.92
ABM64-80	80	1.250	0.813	1.281	1.297	0.500	0.187	£46.60
ABM64-84	84	1.313	0.844	1.344	1.359	0.500	0.187	£46.91
ABM64-85	85	1.328	0.852	1.359	1.375	0.500	0.187	£47.98
ABM64-86	86	1.344	0.859	1.375	1.391	0.500	0.187	£48.93
ABM64-90	90	1.406	0.891	1.438	1.453	0.500	0.187	£50.15
ABM64-92	92	1.438	0.906	1.469	1.484	0.500	0.187	£51.23
ABM64-94	94	1.469	0.922	1.500	1.516	0.500	0.187	£52.29
ABM64-96	96	1.500	0.938	1.531	1.547	0.500	0.187	£53.38
ABM64-100	100	1.563	0.969	1.594	1.609	0.500	0.187	£54.41
ABM64-110	110	1.719	1.047	1.750	1.766	0.500	0.187	£55.46
ABM64-120	120	1.875	1.125	1.906	1.922	0.500	0.187	£67.38
ABM64-130	130	2.031	1.203	2.063	2.078	0.500	0.187	£78.25
ABM64-140	140	2.188	1.281	2.219	2.234	0.500	0.187	£85.72
ABM64-150	150	2.344	1.359	2.375	2.391	0.500	0.187	£91.87
ABM64-200	200	3.125	1.750	3.156	3.172	0.750	0.250	£122.73
ABM64-300	300	4.688	2.531	4.719	4.734	0.750	0.250	£143.15

Anti-backlash

Wormwheels DP 64



Anti-backlash Wormwheels *Materials*

48 DP

STD : Phosphor Bronze PB2
SPECIAL TEETH : between 50 - 160

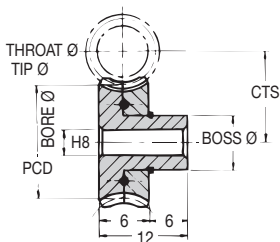

20° Pressure Angle

TORQUE CHECK variations at back	50 TEETH x 1000 R.P.M. INPUT
	with std worm
TORQUE Nm	0.104
K.W.	0.00224

DISCOUNTS

Quantity	List Price
1 - 5	-
6 - 19	- 12%
20 - 39	- 25%
40 - 59	- 33%
60 - 99	- 37%
100 - 200	- 42%

DP 48

Anti-backlash Wormwheels

PART NUMBER	TEETH	PCD (ins)	CTS (ins)	THROAT Ø (ins)	TIP Ø (ins)	BOSS Ø (ins)	BORE Ø (ins)	PRICE EACH 1-5
ABM48-50	50	1.042	0.771	1.083	1.104	0.500	0.250	£43.30
ABM48-52	52	1.083	0.792	1.125	1.146	0.500	0.250	£43.98
ABM48-55	55	1.146	0.823	1.188	1.208	0.500	0.250	£44.67
ABM48-58	58	1.208	0.854	1.250	1.271	0.500	0.250	£45.36
ABM48-60	60	1.250	0.875	1.292	1.313	0.500	0.250	£46.05
ABM48-62	62	1.292	0.896	1.333	1.354	0.500	0.250	£46.69
ABM48-65	65	1.354	0.927	1.396	1.417	0.500	0.250	£47.44
ABM48-68	68	1.417	0.958	1.458	1.479	0.500	0.250	£47.98
ABM48-70	70	1.458	0.979	1.500	1.521	0.500	0.250	£49.00
ABM48-72	72	1.500	1.000	1.542	1.563	0.500	0.250	£50.10
ABM48-75	75	1.563	1.031	1.604	1.625	0.500	0.250	£51.10
ABM48-78	78	1.625	1.063	1.667	1.688	0.500	0.250	£52.15
ABM48-80	80	1.667	1.083	1.708	1.729	0.500	0.250	£53.20
ABM48-82	82	1.708	1.104	1.750	1.771	0.500	0.250	£53.94
ABM48-85	85	1.771	1.135	1.813	1.833	0.500	0.250	£54.70
ABM48-88	88	1.833	1.167	1.875	1.896	0.500	0.250	£55.42
ABM48-90	90	1.875	1.188	1.917	1.938	0.500	0.250	£56.12
ABM48-92	92	1.917	1.208	1.958	1.979	0.500	0.250	£56.83
ABM48-95	95	1.979	1.240	2.021	2.042	0.500	0.250	£57.57
ABM48-96	96	2.000	1.250	2.042	2.063	0.750	0.250	£58.26
ABM48-98	98	2.042	1.271	2.083	2.104	0.750	0.250	£58.95
ABM48-100	100	2.083	1.292	2.125	2.146	0.750	0.250	£58.86
ABM48-110	110	2.292	1.396	2.333	2.354	0.750	0.250	£72.73
ABM48-120	120	2.500	1.500	2.542	2.563	0.750	0.250	£78.99
ABM48-140	140	2.917	1.708	2.958	2.979	0.750	0.250	£86.47
ABM48-150	150	3.125	1.813	3.167	3.188	0.750	0.250	£91.26
ABM48-160	160	3.333	1.917	3.375	3.396	0.750	0.250	£96.09

16.10



<https://amironic.co.il/>

Materials **Anti-backlash Wormwheels**

STD : Phosphor Bronze PB2

SPECIAL TEETH : between 48 - 150

32 DP

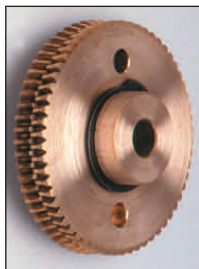
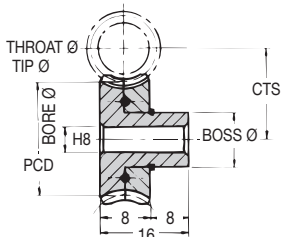

DISCOUNTS

1 - 5	List Price
6 - 19	- 12%
20 - 39	- 25%
40 - 59	- 33%
60 - 99	- 37%
100 - 200	- 42%

TORQUE CHECK variations at back	50 TEETH x 1000 R.P.M. INPUT with std worm
TORQUE Nm	0.288
K.W.	0.00616

20° Pressure Angle

PART NUMBER	TEETH	PCD (ins)	CTS (ins)	THROAT Ø (ins)	TIP Ø (ins)	BOSS Ø (ins)	BORE Ø (ins)	PRICE EACH 1-5
ABM32-48	48	1.500	1.000	1.563	1.594	0.625	0.250	£57.26
ABM32-50	50	1.563	1.031	1.625	1.656	0.625	0.250	£59.49
ABM32-52	52	1.625	1.063	1.688	1.719	0.625	0.250	£61.72
ABM32-54	54	1.688	1.094	1.750	1.781	0.625	0.250	£63.91
ABM32-55	55	1.719	1.109	1.781	1.813	0.625	0.250	£66.12
ABM32-58	58	1.813	1.156	1.875	1.906	0.625	0.250	£68.34
ABM32-60	60	1.875	1.188	1.938	1.969	0.625	0.250	£70.57
ABM32-62	62	1.938	1.219	2.000	2.031	0.625	0.250	£72.73
ABM32-64	64	2.000	1.250	2.063	2.094	0.750	0.312	£76.12
ABM32-65	65	2.031	1.266	2.094	2.125	0.750	0.312	£79.52
ABM32-68	68	2.125	1.313	2.188	2.219	0.750	0.312	£82.87
ABM32-70	70	2.188	1.344	2.250	2.281	0.750	0.312	£86.23
ABM32-72	72	2.250	1.375	2.313	2.344	0.750	0.312	£89.65
ABM32-75	75	2.344	1.422	2.406	2.438	0.750	0.312	£92.98
ABM32-78	78	2.438	1.469	2.500	2.531	0.750	0.312	£95.39
ABM32-80	80	2.500	1.500	2.563	2.594	0.750	0.312	£97.92
ABM32-82	82	2.563	1.531	2.625	2.656	0.750	0.312	£100.38
ABM32-85	85	2.656	1.578	2.719	2.750	0.750	0.312	£102.83
ABM32-88	88	2.750	1.625	2.813	2.844	0.750	0.312	£105.31
ABM32-90	90	2.813	1.656	2.875	2.906	0.750	0.312	£107.74
ABM32-94	94	2.938	1.719	3.000	3.031	0.750	0.312	£110.25
ABM32-96	96	3.000	1.750	3.063	3.094	0.750	0.312	£112.74
ABM32-100	100	3.125	1.813	3.188	3.219	0.750	0.312	£117.45
ABM32-110	110	3.438	1.969	3.500	3.531	0.750	0.312	£122.15
ABM32-120	120	3.750	2.125	3.813	3.844	0.750	0.312	£126.87
ABM32-150	150	4.688	2.594	4.750	4.781	0.750	0.312	£153.14

Anti-backlash

Wormwheels DP 32



Anti-backlash Wormwheels Materials

24 DP

STD : Phosphor Bronze PB2
SPECIAL TEETH : between 48 - 150

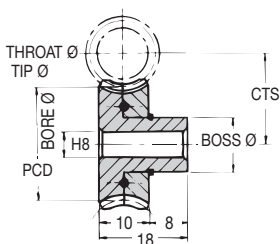

20° Pressure Angle

TORQUE CHECK	50 TEETH x 1000 R.P.M. INPUT
variations at back	with std worm
TORQUE Nm	0.576
K.W.	0.0092

DISCOUNTS

1 - 5	List Price
6 - 19	- 12%
20 - 39	- 25%
40 - 59	- 33%
60 - 99	- 37%
100 - 200	- 42%

Anti-backlash Wormwheels DP 24

PART NUMBER	TEETH	PCD (ins)	CTS (ins)	THROAT Ø (ins)	TIP Ø (ins)	BOSS Ø (ins)	BORE Ø (ins)	PRICE EACH 1-5
ABM24-48	48	2.000	1.313	2.083	2.125	0.750	0.375	£84.56
ABM24-50	50	2.083	1.354	2.167	2.208	0.750	0.375	£87.80
ABM24-52	52	2.167	1.396	2.250	2.292	0.750	0.375	£91.04
ABM24-54	54	2.250	1.438	2.333	2.375	0.750	0.375	£94.23
ABM24-55	55	2.292	1.458	2.375	2.417	0.750	0.375	£97.42
ABM24-58	58	2.417	1.521	2.500	2.542	0.750	0.375	£100.69
ABM24-60	60	2.500	1.563	2.583	2.625	0.750	0.375	£103.90
ABM24-62	62	2.583	1.604	2.667	2.708	0.750	0.375	£107.92
ABM24-64	64	2.667	1.646	2.750	2.792	0.750	0.375	£111.94
ABM24-65	65	2.708	1.667	2.792	2.833	0.750	0.375	£115.97
ABM24-68	68	2.833	1.729	2.917	2.958	0.750	0.375	£119.99
ABM24-70	70	2.917	1.771	3.000	3.042	0.750	0.375	£124.01
ABM24-72	72	3.000	1.813	3.083	3.125	0.750	0.375	£127.95
ABM24-75	75	3.125	1.875	3.208	3.250	0.750	0.375	£131.76
ABM24-78	78	3.250	1.938	3.333	3.375	0.750	0.375	£135.55
ABM24-80	80	3.333	1.979	3.417	3.458	0.750	0.375	£139.33
ABM24-82	82	3.417	2.021	3.500	3.542	0.750	0.375	£143.15
ABM24-85	85	3.542	2.083	3.625	3.667	0.750	0.375	£146.93
ABM24-88	88	3.667	2.146	3.750	3.792	0.750	0.375	£150.79
ABM24-90	90	3.750	2.188	3.833	3.875	0.750	0.375	£154.51
ABM24-94	94	3.917	2.271	4.000	4.042	0.750	0.375	£161.82
ABM24-96	96	4.000	2.313	4.083	4.125	0.750	0.375	£169.12
ABM24-100	100	4.167	2.396	4.250	4.292	0.750	0.375	£176.46
ABM24-110	110	4.583	2.604	4.667	4.708	1.000	0.500	£220.99
ABM24-120	120	5.000	2.813	5.083	5.125	1.000	0.500	£265.50
ABM24-150	150	6.250	2.438	6.333	6.375	1.000	0.500	£370.30

16.12



<https://amironic.co.il/>

Materials **Anti-backlash Wormwheels**

STD : Phosphor Bronze PB2

SPECIAL TEETH : between 45 - 120

20 DP

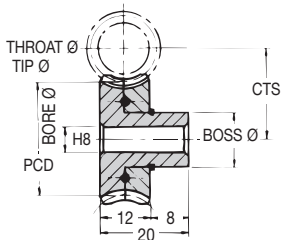

DISCOUNTS

Quantity	List Price
1 - 5	
6 - 19	- 12%
20 - 39	- 25%
40 - 59	- 33%
60 - 99	- 37%
100 - 200	- 42%

TORQUE CHECK variations at back	50 TEETH x 1000 R.P.M. INPUT with std worm
TORQUE Nm	1.12
K.W.	0.0232

20° Pressure Angle

PART NUMBER	TEETH	PCD (ins)	CTS (ins)	THROAT Ø (ins)	TIP Ø (ins)	BOSS Ø (ins)	BORE Ø (ins)	PRICE EACH 1-5
ABM20-45	45	2.250	1.438	2.350	2.400	1.000	0.375	£95.59
ABM20-48	48	2.400	1.513	2.500	2.550	1.000	0.375	£100.31
ABM20-50	50	2.500	1.563	2.600	2.650	1.000	0.375	£105.04
ABM20-52	52	2.600	1.613	2.700	2.750	1.250	0.500	£109.79
ABM20-54	54	2.700	1.663	2.800	2.850	1.250	0.500	£114.53
ABM20-55	55	2.750	1.688	2.850	2.900	1.250	0.500	£119.29
ABM20-58	58	2.900	1.763	3.000	3.050	1.250	0.500	£124.01
ABM20-60	60	3.000	1.813	3.100	3.150	1.250	0.500	£128.84
ABM20-62	62	3.100	1.863	3.200	3.250	1.250	0.500	£133.73
ABM20-64	64	3.200	1.913	3.300	3.350	1.250	0.500	£138.61
ABM20-65	65	3.250	1.938	3.350	3.400	1.250	0.500	£143.53
ABM20-68	68	3.400	2.013	3.500	3.550	1.250	0.500	£148.46
ABM20-70	70	3.500	2.063	3.600	3.650	1.250	0.500	£153.38
ABM20-72	72	3.600	2.113	3.700	3.750	1.250	0.500	£158.15
ABM20-74	74	3.700	2.163	3.800	3.850	1.250	0.500	£162.96
ABM20-75	75	3.750	2.188	3.850	3.900	1.250	0.500	£167.72
ABM20-78	78	3.900	2.263	4.000	4.050	1.250	0.500	£172.50
ABM20-80	80	4.000	2.313	4.100	4.150	1.250	0.500	£177.29
ABM20-82	82	4.100	2.363	4.200	4.250	1.250	0.500	£196.75
ABM20-85	85	4.250	2.438	4.350	4.400	1.250	0.500	£216.14
ABM20-88	88	4.400	2.513	4.500	4.550	1.250	0.500	£235.56
ABM20-90	90	4.500	2.563	4.600	4.650	1.250	0.500	£254.99
ABM20-95	95	4.750	2.688	4.850	4.900	2.000	0.500	£274.47
ABM20-98	98	4.900	2.763	5.000	5.050	2.000	0.500	£293.90
ABM20-100	100	5.000	2.813	5.100	5.150	2.000	0.500	£313.37
ABM20-110	110	5.500	3.063	5.600	5.650	2.000	0.500	£364.26
ABM20-120	120	6.000	3.313	6.100	6.150	2.000	0.500	£415.13

Anti-backlash

Wormwheels DP 20



Anti-backlash Wormwheels Materials

16 DP

STD : Phosphor Bronze PB2
SPECIAL TEETH : between 40 - 95

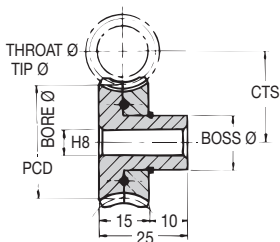

20° Pressure Angle

TORQUE CHECK variations at back	50 TEETH x 1000 R.P.M. INPUT
	with std worm
TORQUE Nm	2.00
K.W.	0.04192

DISCOUNTS

1 - 5	List Price
6 - 19	- 12%
20 - 39	- 25%
40 - 59	- 33%
60 - 99	- 37%
100 - 200	- 42%

Anti-backlash Wormwheels

DP 16

PART NUMBER	TEETH	PCD (ins)	CTS (ins)	THROAT Ø (ins)	TIP Ø (ins)	BOSS Ø (ins)	BORE Ø (ins)	PRICE EACH 1-5
ABM16-40	40	2.500	1.625	2.625	2.688	1.250	0.625	£104.47
ABM16-42	42	2.625	1.688	2.750	2.813	1.250	0.625	£119.04
ABM16-44	44	2.750	1.750	2.875	2.938	1.250	0.625	£133.60
ABM16-45	45	2.813	1.781	2.938	3.000	1.250	0.625	£148.19
ABM16-48	48	3.000	1.875	3.125	3.188	1.250	0.625	£162.69
ABM16-50	50	3.125	1.938	3.250	3.313	1.250	0.625	£177.27
ABM16-52	52	3.250	2.000	3.375	3.438	1.250	0.625	£191.83
ABM16-54	54	3.375	2.063	3.500	3.563	1.250	0.625	£206.38
ABM16-55	55	3.438	2.094	3.563	3.625	1.250	0.625	£215.56
ABM16-58	58	3.625	2.188	3.750	3.813	1.250	0.625	£224.78
ABM16-60	60	3.750	2.250	3.875	3.938	1.250	0.625	£233.97
ABM16-62	62	3.875	2.313	4.000	4.063	1.250	0.625	£243.15
ABM16-64	64	4.000	2.375	4.125	4.188	1.250	0.625	£252.36
ABM16-65	65	4.063	2.406	4.188	4.250	1.250	0.625	£261.47
ABM16-68	68	4.250	2.500	4.375	4.438	1.250	0.625	£279.21
ABM16-70	70	4.375	2.563	4.500	4.563	1.250	0.625	£296.93
ABM16-72	72	4.500	2.625	4.625	4.688	1.250	0.625	£314.68
ABM16-74	74	4.625	2.688	4.750	4.813	2.000	0.625	£332.41
ABM16-75	75	4.688	2.719	4.813	4.875	2.000	0.625	£350.11
ABM16-78	78	4.875	2.813	5.000	5.063	2.000	0.625	£367.87
ABM16-80	80	5.000	2.875	5.125	5.188	2.000	0.625	£385.63
ABM16-82	82	5.125	2.938	5.250	5.313	2.000	0.625	£407.47
ABM16-85	85	5.313	3.031	5.438	5.500	2.000	0.625	£429.37
ABM16-88	88	5.500	3.125	5.625	5.688	2.000	0.625	£451.26
ABM16-90	90	5.625	3.188	5.750	5.813	2.000	0.625	£473.12
ABM16-92	92	5.750	3.250	5.875	5.938	2.000	0.625	£494.97
ABM16-95	95	5.938	3.344	6.063	6.125	2.000	0.625	£516.90

Materials **Anti-backlash Wormwheels**

STD : Phosphor Bronze PB2

SPECIAL TEETH : between 40 - 80

12 DP

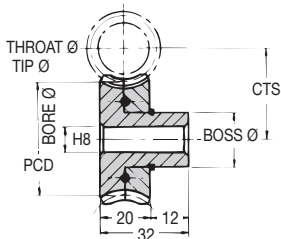

DISCOUNTS

Quantity	List Price
1 - 5	
6 - 19	- 12%
20 - 39	- 25%
40 - 59	- 33%
60 - 99	- 37%
100 - 200	- 42%

TORQUE CHECK variations at back	50 TEETH x 1000 R.P.M. INPUT with std worm
TORQUE Nm	4.80
K.W.	0.10

20° Pressure Angle

PART NUMBER	TEETH	PCD (ins)	CTS (ins)	THROAT Ø (ins)	TIP Ø (ins)	BOSS Ø (ins)	BORE Ø (ins)	PRICE EACH 1-5
ABM12-40	40	3.333	2.167	3.500	3.583	1.500	0.625	£168.68
ABM12-42	42	3.500	2.250	3.667	3.750	1.500	0.625	£192.03
ABM12-44	44	3.667	2.333	3.833	3.917	1.500	0.625	£215.45
ABM12-45	45	3.750	2.375	3.917	4.000	1.500	0.625	£238.84
ABM12-46	46	3.833	2.417	4.000	4.083	1.500	0.625	£262.24
ABM12-48	48	4.000	2.500	4.167	4.250	1.500	0.625	£285.63
ABM12-50	50	4.167	2.583	4.333	4.417	1.500	0.625	£298.80
ABM12-52	52	4.333	2.667	4.500	4.583	1.500	0.625	£311.92
ABM12-54	54	4.500	2.750	4.667	4.750	1.500	0.625	£325.10
ABM12-55	55	4.583	2.792	4.750	4.833	1.500	0.625	£338.25
ABM12-56	56	4.667	2.833	4.833	4.917	1.500	0.625	£351.40
ABM12-58	58	4.833	2.917	5.000	5.083	1.750	0.750	£366.04
ABM12-60	60	5.000	3.000	5.167	5.250	1.750	0.750	£380.70
ABM12-62	62	5.167	3.083	5.333	5.417	1.750	0.750	£395.33
ABM12-64	64	5.333	3.167	5.500	5.583	1.750	0.750	£410.02
ABM12-65	65	5.417	3.208	5.583	5.667	1.750	0.750	£424.67
ABM12-66	66	5.500	3.250	5.667	5.750	1.750	0.750	£439.29
ABM12-68	68	5.667	3.333	5.833	5.917	1.750	0.750	£453.96
ABM12-70	70	5.833	3.417	6.000	6.083	1.750	0.750	£476.43
ABM12-72	72	6.000	3.500	6.167	6.250	1.750	0.750	£498.91
ABM12-74	74	6.167	3.583	6.333	6.417	2.000	0.750	£521.38
ABM12-75	75	6.250	3.625	6.417	6.500	2.000	0.750	£543.90
ABM12-76	76	6.333	3.667	6.500	6.583	2.000	0.750	£566.34
ABM12-78	78	6.500	3.750	6.667	6.750	2.000	0.750	£588.82
ABM12-80	80	6.667	3.833	6.833	6.917	2.000	0.750	£611.26

Anti-backlash

Wormwheels DP 12

