

FASTENERS

Keensert Inserts

Stainless Steel : Lightweight & Heavy Duty Series : To Suit M5 - M12

**KI
KIHD**

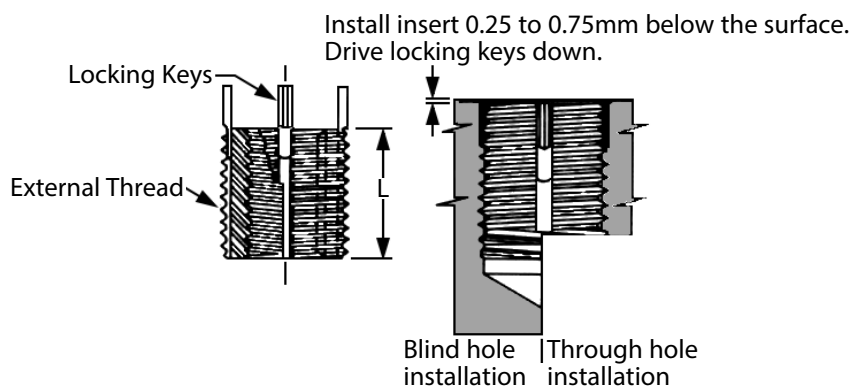

Part Number	Internal Thread Class 5H	Length L ±0.3	External Thread Class 4H*	Tap Drill Dia.	Countersink Dia. ±0.25 -0.00	No. Of Locking Keys	Min. Tapped Hole Depth	Removal Drill Size	Removal Drill Depth
LIGHTWEIGHT SERIES									
KI-5	M5 x 0.8	8	M8 x 1.25	6.90	8.25	2	9.5	5.5	4.00
KI-6	M6 x 1	10	M10 x 1.25	8.80	10.25	2	11.5	7.5	4.75
KI-8	M8 x 1.25	12	M12 x 1.25	10.80	12.25	4	13.5	9.5	4.75
KI-10F	M10 x 1.25	14	M14 x 1.5	12.80	14.25	4	15.5	11.5	4.75
KI-10	M10 x 1.5	14	M14 x 1.5	12.80	14.25	4	15.5	11.5	4.75
KI-12F	M12 x 1.25	16	M16 x 1.5	14.80	16.25	4	17.5	13.5	4.75
KI-12	M12 x 1.75	16	M16 x 1.5	14.80	16.25	4	17.5	13.5	4.75
HEAVY DUTY SERIES									
KIHD-4	M4 x 0.7	8	M8 x 1.25	6.90	8.25	2	9.5	5.5	4.00
KIHD-5	M5 x 0.8	10	M10 x 1.25	8.80	10.25	2	12.5	7.5	4.75
KIHD-6	M6 x 1	12	M12 x 1.25	10.80	12.25	4	14.5	9.5	4.75
KIHD-8	M8 x 1.25	14	M14 x 1.5	12.80	14.25	4	16.5	11.5	4.75
KIHD-10	M10 x 1.5	16	M16 x 1.5	14.75	16.25	4	18.5	13.5	4.75

Material

Insert: 303 Stainless Steel (passivated).

Keys: 302 Stainless Steel.

* Modified minor diameter. External Thread Tap is same size but Class 6H.

Keenserts provide high resistance to torque and pullout.

The keys in each insert are driven down through the threads of the parent material mechanically locking it in place.

These locking keys positively prevent rotation due to torsion or vibration.

Heavy duty series available in larger sizes (up to M24 internal thread, M33 external thread), P.O.A.

Also available in miniature (M2 to M4) and in extra heavy duty.

Internal thread locking available for all versions, P.O.A.

Features

- Easy install, high strength, high cycle life,
- Positive mechanical lock eliminates wind-out in service,
- Significantly increases torque-down and load capability in weaker materials,
- No special taps required,
- No tangs to break off and remove.

Installation & Removal

Drill with a standard drill into the parent material.

Countersink with a standard countersink tool (82° to 100°).

Tap thread into the parent material using a standard tap.

Screw in the keensert

(by hand or with the custom installation tool - available separately, P.O.A.).

The keensert is designed to stop at the correct depth below the surface of the parent material.

Using the installation tool, drive in the keys to achieve positive lock against rotation.

It is unlikely that a keensert insert will ever have to be removed, since their threads are stronger than the original threads.

If removal is necessary, however, they can be removed without causing damage to the parent material and an identical insert can be installed into the original hole.

Further installation and removal information is available on request.



+44 (0)1246 455500



+44 (0)1246 455522

ondrives



sales@ondrives.com



www.ondrives.com

Product information updated May 2017 and subject to change. Please click the product links for prices and availability.

FASTENERS

Expansion Inserts

EX15

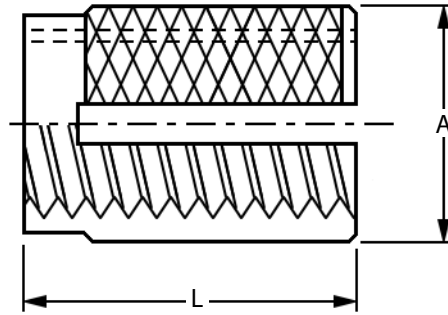

Part Number	Thread Size	Diameter A	Length L	Recommended Hole Size Min. - Max.
EX15-M3	M3	3.96	4.72	4.0 - 4.1
EX15-M3.5	M3.5	4.72	6.32	4.8 - 4.9
EX15-M4	M4	5.50	7.92	5.6 - 5.7
EX15-M5	M5	6.32	9.42	6.4 - 6.5
EX15-M6	M6	7.90	12.70	8.0 - 8.1
EX15-M8	M8	9.50	12.60	9.6 - 9.7

Expansion inserts are used where a durable thread is required but the high pull-out resistance of self-tapping or heat / ultrasonic inserts is not essential. They are hand-placed into a hole of specified size and the action of the screw on final assembly locks the insert into place.

They are ideally suited for use in plastics which are strong enough to resist the expansion of the insert yet flexible enough to allow the knurls to anchor into the material. Expansion Inserts are also available with a flanged head, P.O.A. We can also supply inserts for tapered holes and symmetrical ultrasonic inserts, P.O.A.



+44 (0)1246 455500



+44 (0)1246 455522

ondrives



sales@ondrives.com



www.ondrives.com

Product information updated May 2017 and subject to change. Please click the product links for prices and availability.